

GN 426.6

Stainless Steel-Cabinet "U" handles

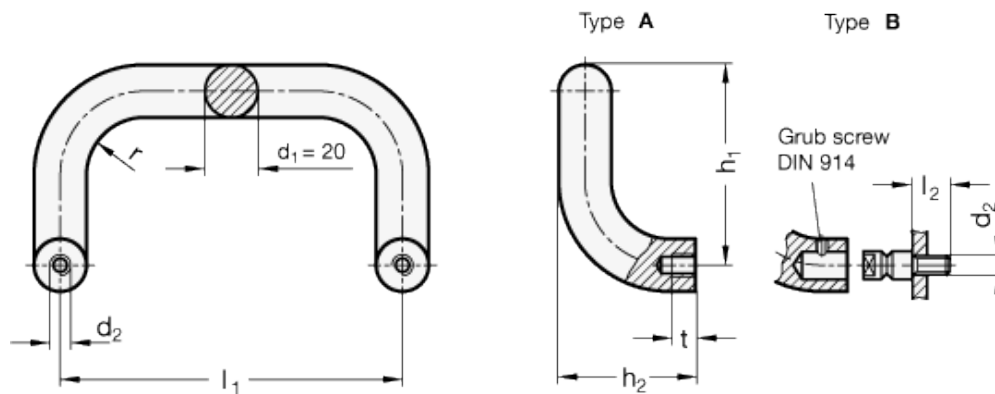

INOX
Stainless Steel



technical informations

Specification

Types

- Type A: Mounting from the back (threaded blind bore)
- Type B: Mounting from the Operators side

Stainless Steel

- AISI 304
- matt shot-blasted

Threaded bush / Mounting stud

Stainless Steel AISI 303

Grub screw DIN-914-M5-6-NI

Information

Stainless Steel-Cabinet "U" handles GN 426.6 can be mounted from the back (type A) as well as from the operator's side (type B). In this case the stud is first screwed in from the machine side and then the handle is pushed on and secured with the grub screw.

Both mounting methods allow the mounting of a pair of handles in opposite position. This method could be used e.g. on doors (double handle). In general, a mounting stud with special length l_2 might be required.

The manufacturing process (bending) allows the production of special lengths in relatively small quantities.

Standard Elements	Main dimensions									Weight
Description	d ₁	l _{1 ±0.25}	l _{1 ±0.3}	d ₂	h ₁	h ₂	l ₂	r	t ₁	g
GN 426.6-20-200-A	20	200	-	M 8	105	68	-	22	15	-
GN 426.6-20-300-A	20	300	-	M 8	105	68	-	22	15	-
GN 426.6-20-200-B	20	-	200	M 8	105	68	20	22	-	-
GN 426.6-20-300-B	20	-	300	M 8	105	68	20	22	-	-



ELESA and GANTER models all rights reserved in accordance with the law. Always mention the source when reproducing our drawings.

STANDARD MACHINE ELEMENTS WORLDWIDE